

# COMMERCIAL DOOR 1900

## LIGHT-DUTY COMMERCIAL GRADE DOOR

SERIES

### DBCI's Commercial Steel Curtain Roll-Up Door Solutions Include:

#### 1900 Series (1950 Insulated)

- 26-gauge Grade E galvanized

#### 2000 Series (2250 Insulated)

- 16-gauge galvanized steel drums with steel ball bearings
- 26-gauge Grade E steel curtain

#### 2500 Series (2750 Insulated)

- Heavy duty
- 10-gauge steel slide bolt lock
- Width up to 18 feet

#### 5000 Series (5250 Insulated)

- Aluminum bottom bar with steel angle reinforcement
- Wind certified up to 20' wide

DBCI's 1900 Series is suitable for a number of light-duty commercial uses. These doors are easy to install and require low maintenance. You will enjoy steady, quiet operation. The 1900 Series utilizes 9 1/2" drums instead of the standard 12" drum. This allows for less headroom when installing the doors. DBCI's commercial-grade steel curtain roll-up doors are designed to meet and/or exceed operational requirements for commercial doors with little or no maintenance.



Integrity. Partnership. Quality.

## Curtain

- 26-gauge galvanized, Grade E hard steel
- Deep-ribbed corrugation
- Maximum opening size of 12' x 14'
- Siliconized polyester WeatherX paint over prime coat
- 20 standard colors, special colors available upon request
- Wash coat over primer interior side
- 30-year film integrity warranty, up to 25-year chalk and fade warranty
- Flexible wear strips
- **NOTE:** The 1900 is not rated for wind loads. Please see the 2500 or 5000.



## Bottom Bar

- 6063 – T6 aluminum extrusion
- 2" x 1 1/2" galvanized angles
- Bulb astragal (Durometer 75)
- Stainless steel nuts and bolts

## Axle-Drum Assembly

- 1 5/16" O.D. steel axle, 14-gauge
- 11-gauge on doors over 10'
- Oil-tempered torsion springs
- Utilizes 9 1/2", 18-gauge drums
- Shielded steel ball bearings in drums
- 26-gauge full top sheet

## A.C.E. Guide System

- Advanced Curtain Engagement guide system
- Galvanized steel
- Adjustable bolt on head stop
- Polyethylene wear strip
- Pre-punched for lock and attachment fasteners

## Hardware

- 13-gauge saddle clamps
- 10-gauge slide locks; two per door
- 16-gauge step plate; two per door
- 1/4" steel angle T-bracket

## Options

- Insulation 1950 Series
- Chain hoist 4:1 reduction
- Vision panels (17" x 5")
- Top draft stop
- Hood
- Steel mounting plates

## Opening Height Headroom

- Up to 10' is 17" of headroom
- 10' to 14' is 19" of headroom

INTERIOR ELEVATION

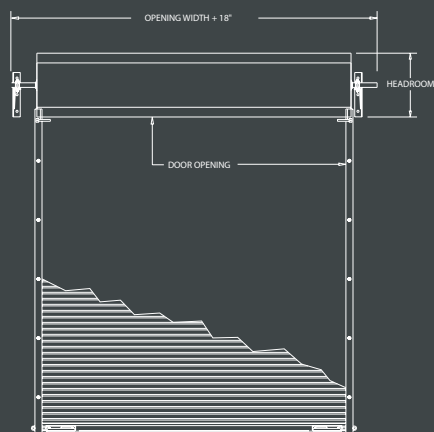

GUIDE DETAIL

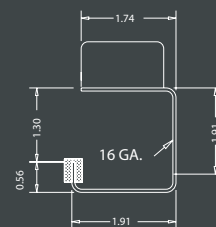

DOOR ENGAGEMENT

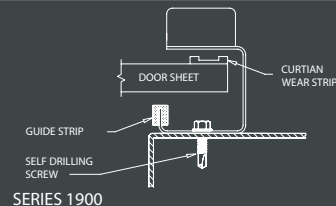

GUIDE MOUNTING

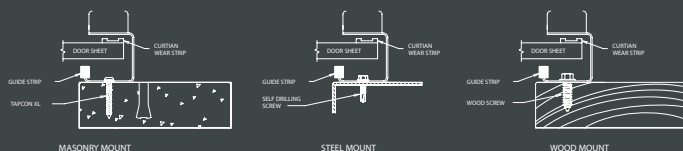

INSULATED DOOR DETAIL

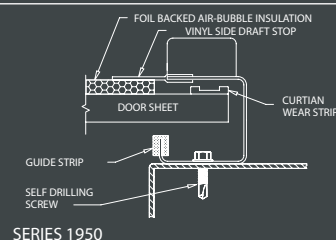

# COMMERCIAL DOOR 2000

## LIGHT DUTY COMMERCIAL GRADE DOOR

SERIES

### DBCI's Commercial Steel Curtain Roll-Up Door Solutions Include:

#### 1900 Series (1950 Insulated)

- 26-gauge Grade E galvanized

#### 2000 Series (2250 Insulated)

- 16-gauge galvanized steel drums with steel ball bearings
- 26-gauge Grade E steel curtain

#### 2500 Series (2750 Insulated)

- Heavy duty
- 10-gauge steel slide bolt lock
- Width up to 18 feet

#### 5000 Series (5250 Insulated)

- Aluminum bottom bar with steel angle reinforcement
- Wind certified up to 20' wide

The 2000 Series is the right choice for light-duty applications requiring frequent usage such as warehouses, freight terminals, car washes, machine shops, auto body shops and much more. The 16-gauge, 12" drums allow for easy retraction. These doors are low-maintenance, which is what every owner wants in a quality door. DBCI's commercial-grade steel curtain roll-up doors are designed to meet and/or exceed operational requirements for commercial doors with little or no maintenance.



Integrity. Partnership. Quality.



## Curtain

- 26-gauge galvanized, Grade E hard steel
- Deep-ribbed corrugation
- Maximum opening size of 12' x 18'
- Flexible wear strips
- **NOTE:** The 2000 is not rated for wind loads. Please see the 2500 or 5000.

## Bottom Bar

- 6063 – T6 aluminum extrusion
- 2" x 1 1/2" galvanized angles
- Bulb astragal
- Stainless steel nuts and bolts

## Axle-Drum Assembly

- 1 5/16" O.D. steel axle, 14-gauge
- 11-gauge axle on doors over 10' wide
- Utilizes 12", 16-gauge drums
- Shielded steel ball bearings in drums
- Full top sheet

## A.C.E. Guide System

- 16-gauge galvanized steel
- Adjustable bolt on head stop
- Polyethylene wear strip
- Pre-punched for lock and attachment fasteners

## Hardware

- Saddle clamps with set fasteners
- 10-gauge slide locks; 2 per door
- 16-gauge step plate; 2 per door
- 1/4" steel angle T-bracket

## Opening Height Headroom

- Doors up to 10' have 20" of headroom
- Doors 10' to 14' have 22" of headroom
- Doors over 14' have 24" of headroom

## Options

- Insulated 2250 Series
- 1900 Series – low overhead option
- Chain hoist 4:1 reduction
- Vision panels (17" x 5")
- Top draft stop
- Hood
- Steel mounting plates
- Electric operator



INTERIOR  
ELEVATION

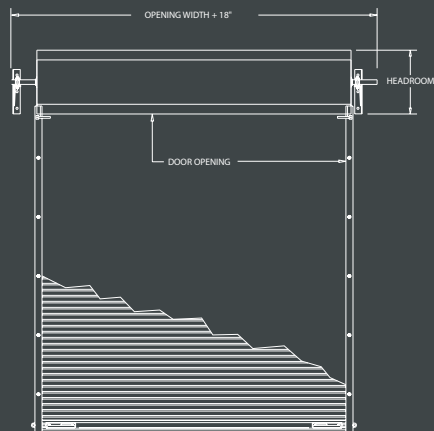

GUIDE  
DETAIL

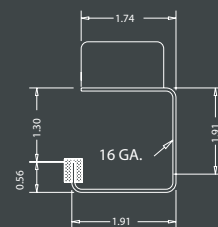

DOOR  
ENGAGEMENT

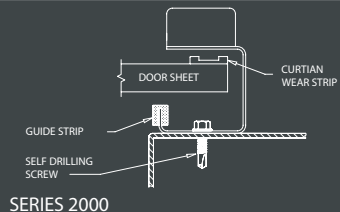

GUIDE  
MOUNTING

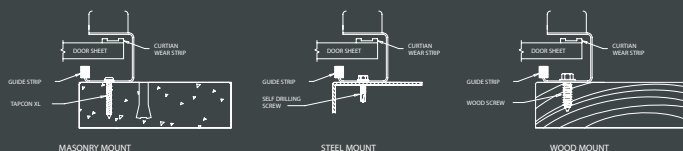

INSULATED  
DOOR DETAIL

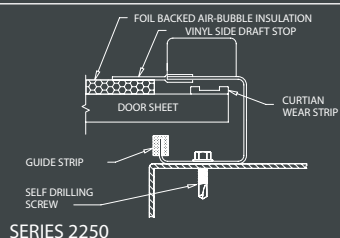

# COMMERCIAL DOOR 2500

## HEAVY DUTY COMMERCIAL GRADE DOOR

SERIES

### DBCI's Commercial Steel Curtain Roll-Up Door Solutions Include:

#### 1900 Series (1950 Insulated)

- 26-gauge Grade E galvanized

#### 2000 Series (2250 Insulated)

- 16-gauge galvanized steel drums with steel ball bearings
- 26-gauge Grade E steel curtain

#### 2500 Series (2750 Insulated)

- Heavy duty
- 10-gauge steel slide bolt lock
- Width up to 18 feet

#### 5000 Series (5250 Insulated)

- Aluminum bottom bar with steel angle reinforcement
- Wind certified up to 20' wide

The 2500 Series is DBCI's heavy duty steel curtain roll-up door with tremendous versatility and unmatched quality. The 2500 Series has deep engagement guides creating greater durability and stronger, longer lasting performance. DBCI's commercial-grade steel curtain roll-up doors are designed to meet and/or exceed operational requirements for commercial doors with little or no maintenance.



Integrity. Partnership. Quality.

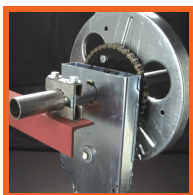
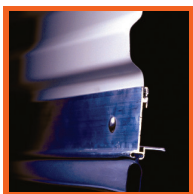
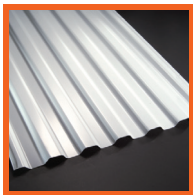

## Curtain

- 26-gauge galvanized, Grade E hard steel
- Deep-ribbed corrugation
- Maximum opening size of 18' x 18'
- Flexible wear strips
- **NOTE:** The 2500 Series are wind rated up to 12'0" wide and approximately 90 MPH. The MPH rating increases as the door width decreases. For test results on doors up to 12'0" wide, please contact DBCI Sales at 800.542.0501.

## Bottom Bar

- 6063 – T6 aluminum extrusion
- 2" x 1 1/2" galvanized angles
- Bulb astragal
- Stainless steel nuts and bolts

## Axle-Drum Assembly

- 1 5/16" O.D. steel axle, 14-gauge
- 11-gauge axle on doors over 10' wide
- Utilizes 12", 16-gauge drums
- Shielded steel ball bearings in drums
- Full top sheet
- Oil tempered torsion springs

## A.C.E. Guide System

- 14-gauge galvanized steel
- Adjustable bolt on head stop
- Polyethylene wear strip
- Pre-punched for lock and attachment fasteners

## Hardware

- Saddle clamps with set fasteners
- 10-gauge slide locks; 2 per door
- 16-gauge step plate; 2 per door
- 1/4" steel welded angle T-bracket

## Opening Height Headroom

- Doors up to 10' have 20" of headroom
- Doors 10' to 14' have 22" of headroom
- Doors over 14' have 24" of headroom

## Options

- Insulated 2750 Series
- Chain hoist 4:1 reduction
- Vision panels (17" x 5")
- Top draft stop
- Hood
- Steel mounting plates
- Electric operator
- Low headroom 2400 Series

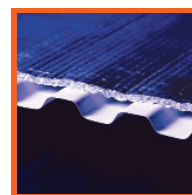
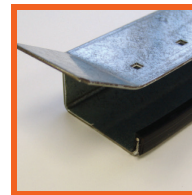

### INTERIOR ELEVATION

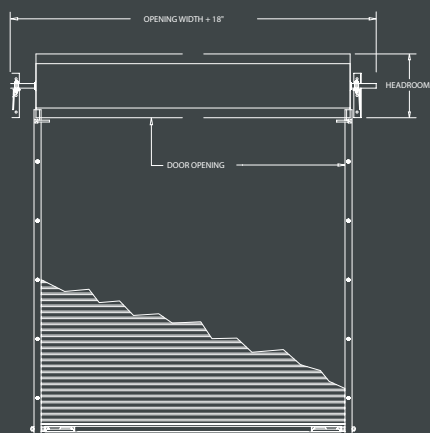

### GUIDE DETAIL

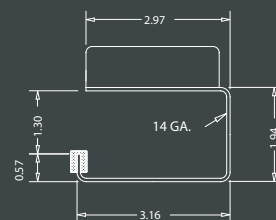

### DOOR ENGAGEMENT

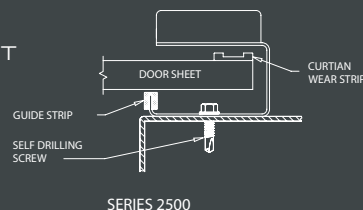

SERIES 2500

### GUIDE MOUNTING

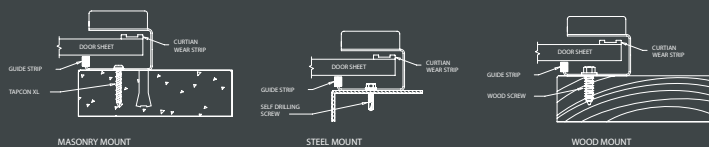

### INSULATED DOOR DETAIL

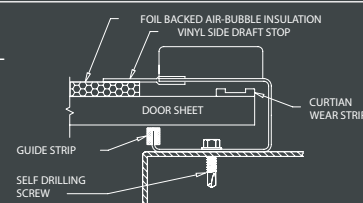

SERIES 2750



# COMMERCIAL DOOR 5000

## WIND CERTIFIED DOOR

SERIES

### DBCI's Commercial Steel Curtain Roll-Up Door Solutions Include:

#### 1900 Series (1950 Insulated)

- 26-gauge Grade E galvanized

#### 2000 Series (2250 Insulated)

- 16-gauge galvanized steel drums with steel ball bearings
- 26-gauge Grade E steel curtain

#### 2500 Series (2750 Insulated)

- Heavy duty
- 10-gauge steel slide bolt lock
- Width up to 18 feet

#### 5000 Series (5250 Insulated)

- Aluminum bottom bar with steel angle reinforcement
- Wind certified up to 20' wide

When it comes to withstanding Mother Nature's wrath, DBCI has the doors you need. Our 5000 Series utilizes deep engagement guides and side curtain windlocks that are designed to maintain the operation integrity of the door and meet most state and local building codes, especially in coastal regions and Florida. The 5000 Series is made of 26-gauge, Grade E hard steel to ensure quality and dependability. DBCI's commercial-grade steel curtain roll-up doors are designed to meet and/or exceed operational requirements for commercial doors with little or no maintenance.



Integrity. Partnership. Quality.

Fueled by constant changes in local and national building codes, as well as increasing insurance costs, doors with validated wind certification can dramatically reduce maintenance and replacement costs and minimize downtime. DBCI's wind-certified doors are designed to meet stringent building codes in coastal regions and Florida.

## Curtain

- 26-gauge galvanized, Grade E hard steel
- Deep-ribbed corrugation with three-rivet windlock attachment
- Maximum opening size of 20' x 16'
- Flexible wear strips
- **NOTE:** The 5000 Series are wind rated up to 20'0" wide and approximately 120 MPH. The MPH rating increases as the door width decreases. For test results on doors up to 20'0" wide, please contact DBCI Sales at 800.542.0501.

## Approximate\* MPH Certification

- 10' wide = 150 mph
- 12' wide = 150 mph
- 14' wide = 146 mph
- 16' wide = 140 mph

*\*For test results on doors up to 20' wide, please contact DBCI Commercial Sales at 800.542.0501.*

## Bottom Bar

- 6063 – T6 aluminum extrusion
- 2" x 1 1/2" galvanized angles
- Bulb astragal
- Stainless steel nuts and bolts

## Axle-Drum Assembly

- 1 5/16" O.D. steel axle, 14-gauge
- 11-gauge axle on doors over 10' wide
- Utilizes 12", 16-gauge drums
- Shielded steel ball bearings in drums
- Full top sheet
- Oil tempered torsion springs

## A.C.E. Guide System

- 12-gauge galvanized steel
- 12-gauge wind lock bar
- Adjustable bolt on head stop
- Polyethylene wear strip
- Pre-punched for lock and attachment fasteners

## Hardware

- Saddle clamps with set fasteners
- 10-gauge slide locks; 2 per door
- 16-gauge step plate; 2 per door
- 1/4" steel angle T-bracket

## Opening Height Headroom

- Doors up to 10' require 20" of headroom
- Doors 10' to 14' require 22" of headroom
- Doors over 14' require 24" of headroom

## Options

- Chain hoist 8:1 reduction
- Header seal
- Hood
- Steel mounting plates
- Electric operator

*\*Also available with insulation (5250 Series)*

### INTERIOR ELEVATION

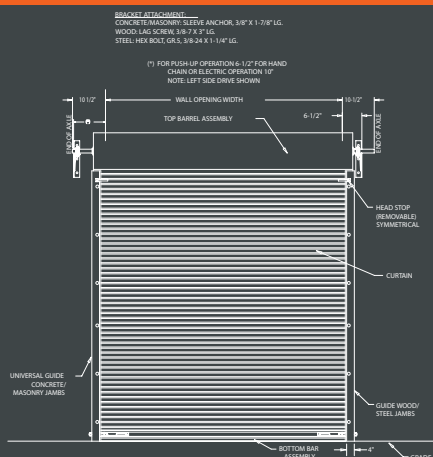

### DOOR ENGAGEMENT

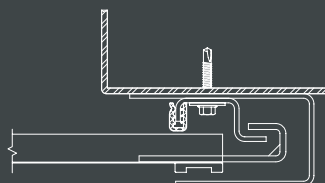

### GUIDE DETAIL

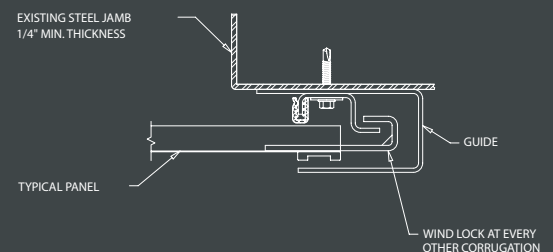

### GUIDE MOUNTING

