

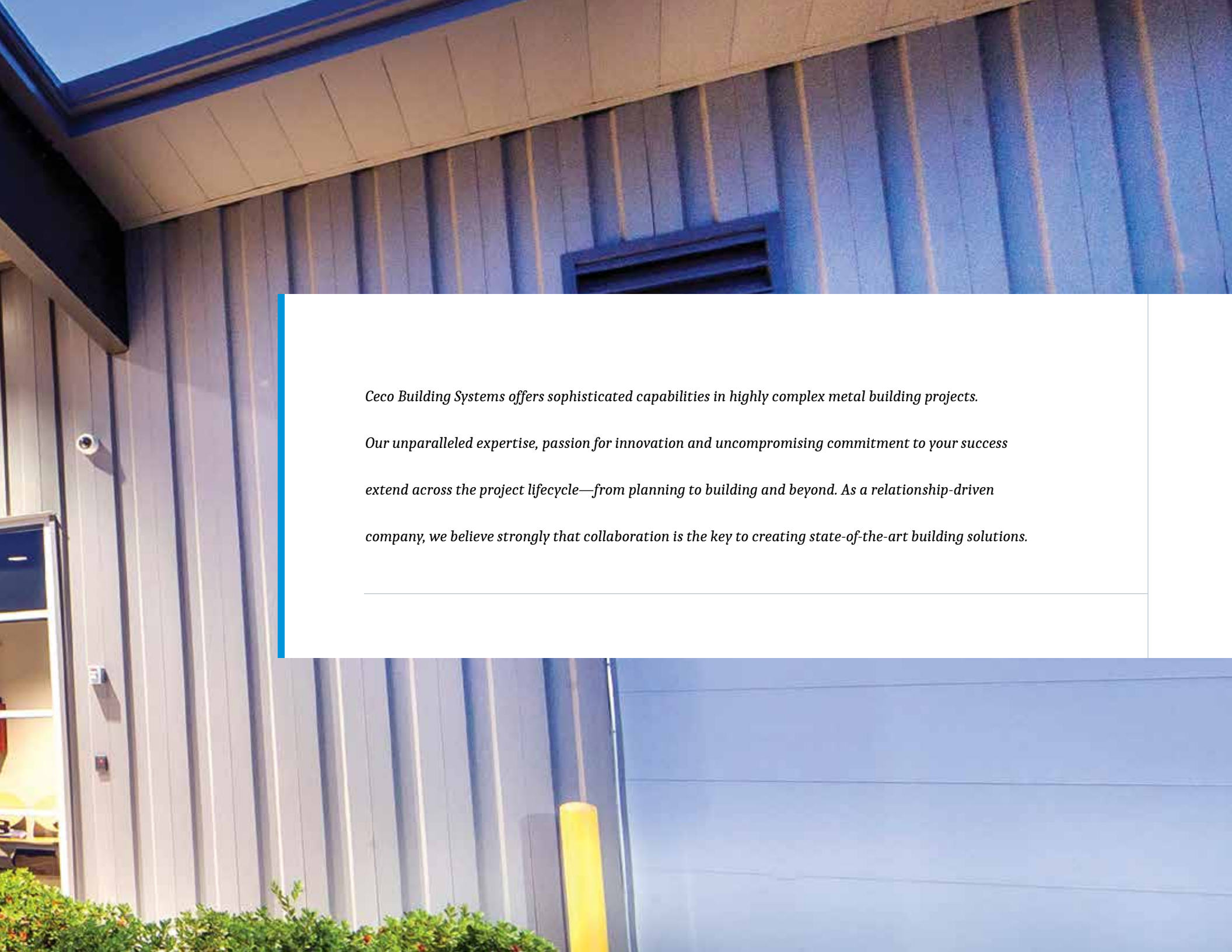

CREATING THE BUILDINGS OF TOMORROW. *Together.*





Ceco Building Systems offers sophisticated capabilities in highly complex metal building projects.

Our unparalleled expertise, passion for innovation and uncompromising commitment to your success extend across the project lifecycle—from planning to building and beyond. As a relationship-driven company, we believe strongly that collaboration is the key to creating state-of-the-art building solutions.



STATE-OF-THE-ART DESIGN MEETS INDUSTRY-LEADING AUTOMATION

We are inspired every day to create cutting-edge buildings that deliver personality, functionality and unique aesthetics. Whether your project demands sophisticated design styling, optimization for rapid expansion or a specialized feature set tailored to a particular industry, we can guide you to the right solution.

Every project is a dialog that we proactively engage in from concept to completion. Our dedicated project team works closely with you to achieve your goals—from the smallest detail to the finished structure. Our state-of-the-art manufacturing facilities utilize industry-leading automation technology to produce the highest quality and consistency in the industry. At Ceko, we take pride in ensuring every product we make is meticulously designed to achieve superior strength, durability and design flexibility.



EXCELLENCE THROUGH COLLABORATION: JOIN OUR AUTHORIZED BUILDER NETWORK

When you join Ceko's Authorized Builder program, you gain a powerful advantage over the competition as well as a number of exclusive resources:

- ◆ Proprietary pricing and project tracking tools to increase your design and estimating efficiency
- ◆ Marketing programs designed to strengthen your brand and expand your reach
- ◆ Training and education opportunities to help you grow your business

There are countless advantages to becoming a Ceko Authorized Builder. Join and you will also become part of one of the largest networks of prefabricated metal building professionals in the world—as well as a vertically integrated business with unlimited solutions for your metal building needs.





BUILDER TOOLS & SYSTEMS

BUILDER'S GATEWAY

The Builder's Gateway is an online portal providing a consolidated view of your account. The Gateway enables Ceko builders to manage projects and access order documentation in real time. The customizable interface provides easy access to critical information, including key resources, upcoming events, builder news, shared leads and more.

CECO PRO®

Our proprietary estimating software, Ceko PRO®, is one of the most robust systems in the industry for designing and pricing medium- to high-complexity buildings. It is a step-by-step, easy-to-use tool that incorporates a broad array of design parameters and accessories to help you achieve the most efficient layout for your project.

CBS-XPRES®

For low-complexity buildings that require quick turnaround, look no further than CBS-Xpres®. Our advanced web-based system greatly simplifies the pricing process, allowing you to generate a metal building quote based on your specifications in a matter of minutes. CBS-Xpres significantly reduces the amount of time it takes to detail and design low-complexity projects by automating core functions. Best of all, it offers an impressive variety of options and accessories when it comes to the design of your building.

CUSTOM-ENGINEERED METAL BUILDINGS





Metal building systems provide an ideal alternative to conventional construction solutions, with more benefits and greater flexibility to meet your project needs and cut time off your construction schedule. Ceco engineers and fabricates a wide range of metal building systems, which vary in shape, size and function yet offer singularly exceptional performance to withstand the long-term effects of the elements. Our custom-designed framing systems provide diverse options for purlins, rafters, bridging and end frame connections and are compatible with multiple wall and roof systems.



FRAMING SYSTEMS

Primary frames span the width of a building and are designed for full bay loading. Our primary steel frame system includes interior building frames, building end frames (rafters, corner posts and end posts), building bracing and crane systems.



SECONDARY SYSTEMS

Ceco's secondary structural framing systems include purlins, girts, eave struts, base members, flange bracing, gable angles, clips and more. These essential components support roof and wall coverings, carry exterior loads and can be formed to fit specific project requirements.



BUILDING BRACING

Each project is engineered to withstand specific wind or seismic load requirements using components from our extensive bracing system, allowing for diaphragm bracing, cable bracing, rod bracing or portal frames.



BENEFITS OF CECO BUILDING SOLUTIONS

Spanning from simple agricultural structures to large, extraordinarily complex aircraft hangars and beyond, each of our unique building solutions is custom designed to achieve your vision while producing several other benefits.

FASTER CONSTRUCTION

Cut weeks off your building construction time, saving time and money.

INTERIOR DESIGN FLEXIBILITY

Designs can be expanded to fit your needs as your business grows, easily and affordably providing you with a clear, column-free interior space.

LONGEVITY

Produced using only high-grade metal and premium components. You can be sure that your investment will be built to last and will serve you well for years to come.

STRENGTH AND DURABILITY

Metal buildings are more likely to survive harsh weather conditions than other types of construction materials. They are designed to withstand the long-term effects of the elements and pests such as termites.

LOW MAINTENANCE

Today's long-life finishes provide years of care-free beauty. An engineered metal building will require less maintenance than similar structures made from other types of materials.

ENERGY EFFICIENCY

All structures are easily insulated with fiberglass, rigid board or insulated metal panels. Insulated panel systems, low-profile roof options and roof color can also significantly reduce energy costs.

SUSTAINABILITY

Metal is recyclable, enabling you to reduce overall environmental impact. Green products such as metal roofs and walls are cited in building codes and standards throughout the country.



FURNISH & ERECT SERVICES

Ceco builders have access to a robust network of certified professionals providing end-to-end furnish and erect services. We work with you to select the best team possible to ensure the integrity of our product and the success of your project.

SERVICES INCLUDE:

- ◆ Ceco authorized network of certified erectors
- ◆ Single-source responsibility for erection of building
- ◆ Ceco applied directives for bonded services as required
- ◆ Competitive pricing structure built on long-standing relationships with our preferred erectors
- ◆ Reliable troubleshooting, field service and follow-up during and after the sale and erection
- ◆ Stringent safety requirements to fit project scenarios as required

LONG BAY®

YOUR CLEAR-SPAN BUILDING SOLUTION

Ceco's Long Bay® system utilizes open web truss secondary framing, providing roof support while allowing greater access to mechanical and electrical systems. Compatible with multiple wall and roofing systems, it provides you with amplified flexibility in construction design. Long Bay is also the perfect solution for manufacturing, distribution and large retail applications.

The single-source design, fabrication and schedule control eliminates inconsistencies and interruptions during the entire building design and erection process. Long Bay purlins are bolted to the rafter, not welded, requiring 50% less horizontal bridging than a bar joist. Horizontal bridging is attached with self-drilling screws versus welding with a typical bar joist. Bolting also allows the erector to connect materials on the ground and lift in sections during installation. This produces substantial labor cost savings, improves on-site safety and increases speed to market.

Long Bay is offered in bays from 40' and up to 70', allowing increased flexibility in design for fewer interior columns. Stiffer and lighter than a traditional bar joist, it can interface with load-bearing masonry or tilt-wall construction and offers a faster, more precise installation. Long Bay is easy to handle, maneuver and erect with no warp or sweep.





INSULATED METAL PANELS

ENERGY-EFFICIENT ENVELOPE SOLUTIONS DESIGNED FOR UNPARALLELED PERFORMANCE

Insulated metal panels (IMPs) offer exceptional insulation and weatherproofing properties at a highly competitive installation cost, making them ideally suited for use as walls, ceilings and roofs in commercial, industrial and institutional buildings of virtually any scale—and in both new and retrofit construction applications.

IMPs deliver superior thermal performance and are built to ensure complete design and code compliance. The metal and foam composite construction forms a strong, rigid panel, increasing the span capacity and reducing the need for secondary structural steel components. Plus, our IMPs are available in a wide range of colors and exterior profiles to complement any design aesthetic.

BENEFITS:

- ◆ Ease and speed of installation
- ◆ Energy efficiency
- ◆ Design flexibility
- ◆ Durability and longevity
- ◆ Environmentally friendly
- ◆ Low maintenance
- ◆ Cost effective

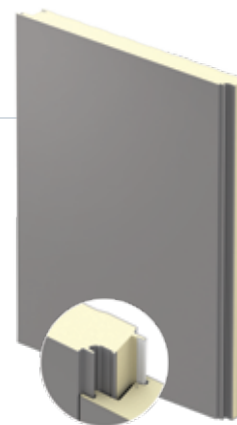

SINGLE-SOURCE PORTFOLIO

INTEGRATED SOLUTIONS FOR NEXT-LEVEL PROJECTS

As part of the Cornerstone Building Brands family, Ceko provides its customers with single-source access to the broadest spectrum of products and service offerings anywhere in the industry, from single skin and insulated metal panels to custom-engineered building systems. Our fully integrated supply chain allows us to maintain the absolute highest standards in quality, backed by unparalleled design and engineering expertise.

OUR PARTNERS INCLUDE:



As the leading manufacturer of single-skin metal roof and wall systems in the nation, MBCI delivers a comprehensive portfolio of products and solutions across a variety of industries.



Operating across the United States and Canada, Metl-Span manufactures insulated metal panels to serve the architectural, commercial, industrial and cold storage industries.



DBCI is a leading national manufacturer of commercial-grade steel curtain roll-up doors, self-storage doors and hallway systems.



With CENTRIA's wide range of products and services, our customers can create visually inspiring, high-performance facades. From high-end insulated metal panels to a wide palette of rainscreen panels and coating systems, CENTRIA products have delivered aesthetics, performance, innovation, sustainability and value for over 100 years.



Environmental StoneWorks offers a turnkey solution for architectural stone veneer, including both materials and installation services—as well as warranties for both.



ROOF AND WALL SYSTEMS

Ceco delivers unmatched performance and superior flexibility across the industry's most robust selection of metal roof and wall products and panel systems. We supply more than 90 variations of metal roof and wall panels to meet your design requirements, as well as secondary structural components, trim and related accessories.

From single skin and insulated metal panels to exposed fastener, concealed fastener and interior wall liner panel systems, each solution is tailored to fit your unique needs. The following is a selection of our most popular roof and wall panels. For detailed information about our other products, please contact your sales or builder services representative.



STANDING SEAM ROOF PANELS

Durable and Weathertight Against the Elements

Recognized for their extreme durability and resistance to inclement weather, Ceco's standing seam metal roofing solutions are independently tested for water penetration, uplift ratings and structural performance to meet or exceed code requirements for your building.



EXPOSED FASTENING PANELS

Proven Performance Meets Design Versatility

Exposed fastening panels have stood the test of time and are the industry's go-to category for metal buildings. With a long history of reliability and performance, these panels still offer the design flexibility expected in modern designs and most can be installed horizontally or vertically on wall applications.



CONCEALED FASTENING PANELS

Shadows and Eyelines Create Amazing Aesthetics

Metal roof and walls that use concealed fastening panels combine elegant design with the toughness of metal. Primarily used in architectural applications, these siding panels are also an appealing choice for residential and commercial applications.



INSULATED METAL PANELS

Energy Efficient and Built to Last

Insulated metal panels, or IMPs, address the four critical performance barriers (water, air, vapor, thermal) in a single component consisting of metal skins and a foam insulating core. IMPs act simultaneously as the exterior facade, insulation and finished interior wall, offering the most advanced protection possible over the lifespan of a building. Whether your project requires unique aesthetic or performance considerations, or even fire-resistant capabilities, these panels offer the ultimate in design freedom and flexibility.

INSULATED COMPOSITE BACKUP SYSTEMS

The Ultimate Barrier System

Designed with CENTRIA's innovative advanced thermal and moisture protection (ATMP) technology, MetalWrap™ Integrated and MetalWrap™ Long Span Series feature integral attachment systems for multiple materials, making these systems the perfect choice for mixed-medium exteriors. MetalWrap™ insulated composite backup panels serve as the ultimate backup wall for nearly any type of exterior rainscreen system, from single-skin metal to brick, terra cotta and others.

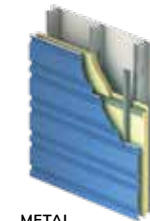

METAL



BRICK

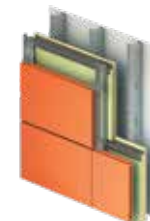

TERRA COTTA



STUCCO

SIGNATURE® COLORS & COATINGS









Whether you are looking for subtle earth tones or striking primaries, Ceco has color offerings to finish your building. All roof and wall panel paint options are SR and SRI rated so solar reflectivity and LEED compliance are easily achieved.

COMMERCIAL/INDUSTRIAL COLOR OPTIONS

SIGNATURE® 200 *Siliconized Polyester*

	Hawaiian Blue		Koko Brown		Charcoal Gray
	Cobalt Blue		Desert Sand		Ash Gray
	Fern Green		Saddle Tan		Solar White
	Rustic Red		Light Stone		Polar White
	Crimson Red		Burnished Slate		Galvalume Plus®

SIGNATURE® 300 *PVDF, Low Gloss*

	Harbor Blue		Medium Bronze		Bone White
	Classic Green		Brownstone		Snow White
	Brite Red		Almond		Slate Gray

Additional colors are available for insulated metal panels. Contact your district sales manager for details. Final color selection should be made from metal color chips.



TUFF-CAST™ TEXTURED FINISH

Look of finished precast concrete with the efficiency of an insulated metal panel. Available on select Metl-Span panels.



TUFF WALL® TEXTURED FINISH

Tuff-Wall is an attractive stucco-like insulated metal wall panel that exhibits the natural beauty sought out by many designers and owners. Available on select Metl-Span panels.

ARCHITECTURAL COLOR OPTIONS

SIGNATURE® 200 *Siliconized Polyester*

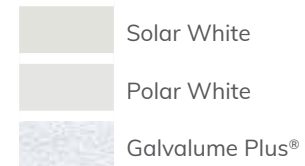
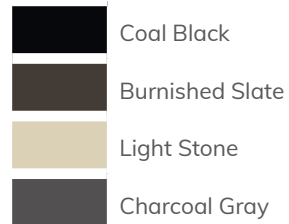

SIGNATURE® 300 *PVDF; Low Gloss*



SIGNATURE® 300 *Metallic Premium Colors*



Metallic coatings are directional. Panels and trim must be installed oriented in the same direction to prevent perceived shade variances.

INDUSTRY PORTFOLIO

From aviation to education and from retail to healthcare, Ceco supports a wide variety of industries. Our buildings can be found across North America and the Caribbean—in rural communities and metropolitan areas alike. Our metal building solutions provide an ideal alternative to conventional construction, with more benefits and greater flexibility to meet your project needs and achieve your business goals.



AGRICULTURAL

Strong & Economical Structures

Ceco serves the agricultural industry by offering a wide range of products built to sustain the intensive, day-to-day demands of even the harshest environments. Whether your needs include equipment storage, dairy barns, animal feedlots or equestrian arenas, our metal building products and solutions provide superior strength and durability to protect your investments in any weather or climate.



AUTOMOTIVE

Tailored Automotive Applications

From parking garages and tire shops to dealerships, showrooms and beyond, Ceco delivers a wide array of metal building products and solutions to the automotive industry. Regardless of your individual project requirements, we offer superior durability and design flexibility, plus fast construction to help get your structure open for business as quickly as possible.



AVIATION

Custom Hangar Design & Supply

Ceco offers a wide range of customized aviation products to ensure your structure will stand up to even the harshest environments. Whether your needs include aircraft hangars or maintenance facilities, our metal building products and solutions provide superior strength and durability to protect your investments in any weather or climate.



COMMUNITY

Beautiful Buildings Bringing People Together

Ceco delivers a wide array of metal building products and solutions to communities across the country. Whether your needs include churches, synagogues, meeting rooms, theaters or multipurpose spaces, our products can be combined with a variety of finishing materials to meet local zoning requirements, accent your building's beauty and enhance the immediate surroundings.



DISTRIBUTION & WAREHOUSE

Large-Scale Structures for a Variety of Applications

Whether you are erecting a distribution facility or a warehouse, Ceco delivers a comprehensive array of metal building products and solutions to accommodate the large, unobstructed interior floor spaces your operations demand. Regardless of your individual business requirements, we offer superior durability and easy maintenance to protect and support your investment in even the harshest environments.

INDUSTRY PORTFOLIO *Continued*



EDUCATIONAL

Safe, Sound Structures That Last for Generations

Whether your project is a grade school, government building or municipal facility, Ceko provides a wide range of metal building products and solutions to meet your unique needs. Large, clear spans and customizable layouts provide incredible design flexibility, while metal delivers long-term cost efficiency and superior durability to ensure your structure will remain an asset to the community for years to come.



HEALTHCARE

Flexible Structural Designs

Ceko delivers a wide range of metal building products and solutions to the healthcare and pharmaceutical industries. Whether your needs include office complexes, clinics or hospitals, our materials are engineered to the exacting specifications and tolerances that your facility demands. Plus, metal components facilitate fast construction to help get your business erected, open and saving lives as quickly as possible.



MANUFACTURING & INDUSTRIAL

Powerful Production Facilities

From simple structures to large, complex facilities, Ceko offers a wide range of products built to sustain the punishing day-to-day demands of manufacturing. Our experts can develop a custom design to accommodate various piping loads, air handling systems, racking loads, mezzanine systems, heavy crane systems and more—all while supporting maximum functionality and energy efficiency.



OFFICE

Distinctive Business Spaces

From commercial office buildings to government facilities, Ceko delivers a wide range of metal building products and solutions to meet your unique needs. By offering an array of exterior panel types, finishes and colors, we accommodate incredible design flexibility. Materials such as glass, stone and masonry can also be integrated to create an attractive, efficient structure that will last for years to come.



RECREATIONAL

Versatile Steel Solutions to Fit Your Needs

Whether your project is an ice-skating rink, recreational center, swimming pool or sports arena, Ceko delivers a wide range of metal building products and solutions to meet your unique needs. Large, clear spans provide unobstructed interior floor space, while metal delivers long-term cost efficiency and superior durability to ensure your structure will remain an asset to the community for years to come.



RETAIL & DINING

Attractive Commercial Solutions

From shopping centers and strip malls to restaurants, showrooms and beyond, Ceko delivers a wide range of metal building products and solutions to the retail and restaurant industries. Regardless of your individual business requirements, we offer superior durability and design flexibility, plus fast construction to help get your structure erected and open as quickly as possible.





THE CORNERSTONE ADVANTAGE

As the largest manufacturer of exterior building products in North America, Cornerstone Building Brands is uniquely positioned to meet the changing needs of our customers. Our family of industry-leading brands spans the breadth of the market to provide the expert support your projects demand.

- ◆ **Relentless Customer Focus:** Our dedicated team of hundreds of sales and service professionals are available to help you and work side-by-side on every challenging project or product inquiry.
- ◆ **Commitment to Innovation and R&D:** Our culture of innovation drives us to continually develop fresh solutions that improve product performance, energy efficiency and ease of use.
- ◆ **Expansive National Footprint:** We are where you need us, with 80+ manufacturing facilities strategically located to deliver on the unique demands of your project.
- ◆ **#1 Manufacturer in North America:** We are the trusted leader in windows, vinyl siding, insulated metal panels, metal roof and wall systems and metal accessories.
- ◆ **Comprehensive Product Portfolio:** We are a one-stop-shop for commercial and residential exteriors. Limitless color and design options allow you the flexibility to truly customize each project.

COLLABORATION AND INNOVATION CREATE THRIVING COMMUNITIES

Our building solutions are the cornerstone of the communities we serve. We believe every building we create, and every part of that building, positively contributes to communities where people live, work and play. That is why every action we take centers around our four core values: Safety, Innovation, Integrity, Teamwork.

At Ceco, we are relentlessly committed to our customers and to creating great building solutions that enable communities to grow and thrive.

CONTACT US TODAY

Let's work together to create the building solutions of tomorrow.

PHONE: 800-474-CECO

EMAIL: SALES@CECOBUILDINGS.COM

ONLINE: CECOBUILDINGS.COM





Descriptions and specifications contained herein were in effect at the time this publication was approved for printing. In a continuing effort to refine and improve products, Ceco Building Systems reserves the right to discontinue products at any time or change specifications and/or designs without incurring obligation. To ensure you have the latest information available, please inquire or visit our website at www.cecobuildings.com.



CECOBUILDINGS.COM | [800-474-CECO](tel:800-474-CECO) | SALES@CECOBUILDINGS.COM

©2020 Ceco Building Systems, Part of the Cornerstone Building Brands Family. All Rights Reserved.
0509209991101/EBS/CG/0920